

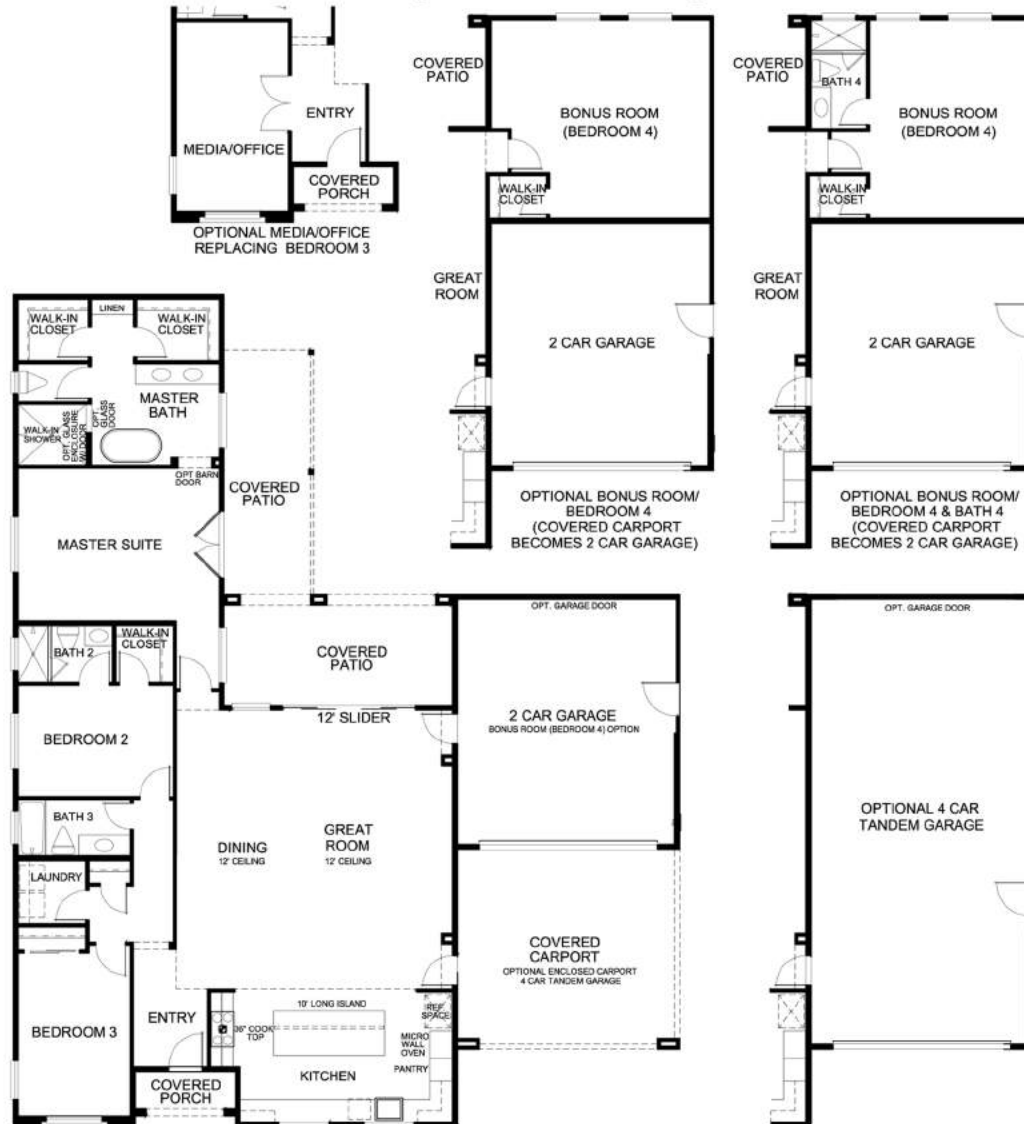

A B C D

One Story 2,178/2,557 Sq. Ft. - 3 to 4 Bedrooms - 3 to 4 Baths - 2 or 4 Car Garage
 Large Great Room w/12' Ceiling - Kitchen with Island - Spacious Master Suite w/ Patio
 In-Suite Bedroom - Opt. Media/Office - Opt. Bonus Room



West Star Construction reserves the right to change elevations, specifications, materials, and prices without notice. All square footages are approximate. Window location, porches, ceiling heights and room dimensions vary per elevation. The availability of certain options is subject to construction status and schedule. Optional features may be predetermined and included at additional cost on select homes. Renderings are artist's conception only.

www.kingsburgnewhomes.com
info@kingsburgnewhomes.com